

UNIT, DIRECT SUPPORT, AND GENERAL SUPPORT MAINTENANCE  
REPAIR PARTS AND SPECIAL TOOLS LIST  
TRUCK, 5-TON, 6X6, M809 SERIES TRUCKS (DIESEL)

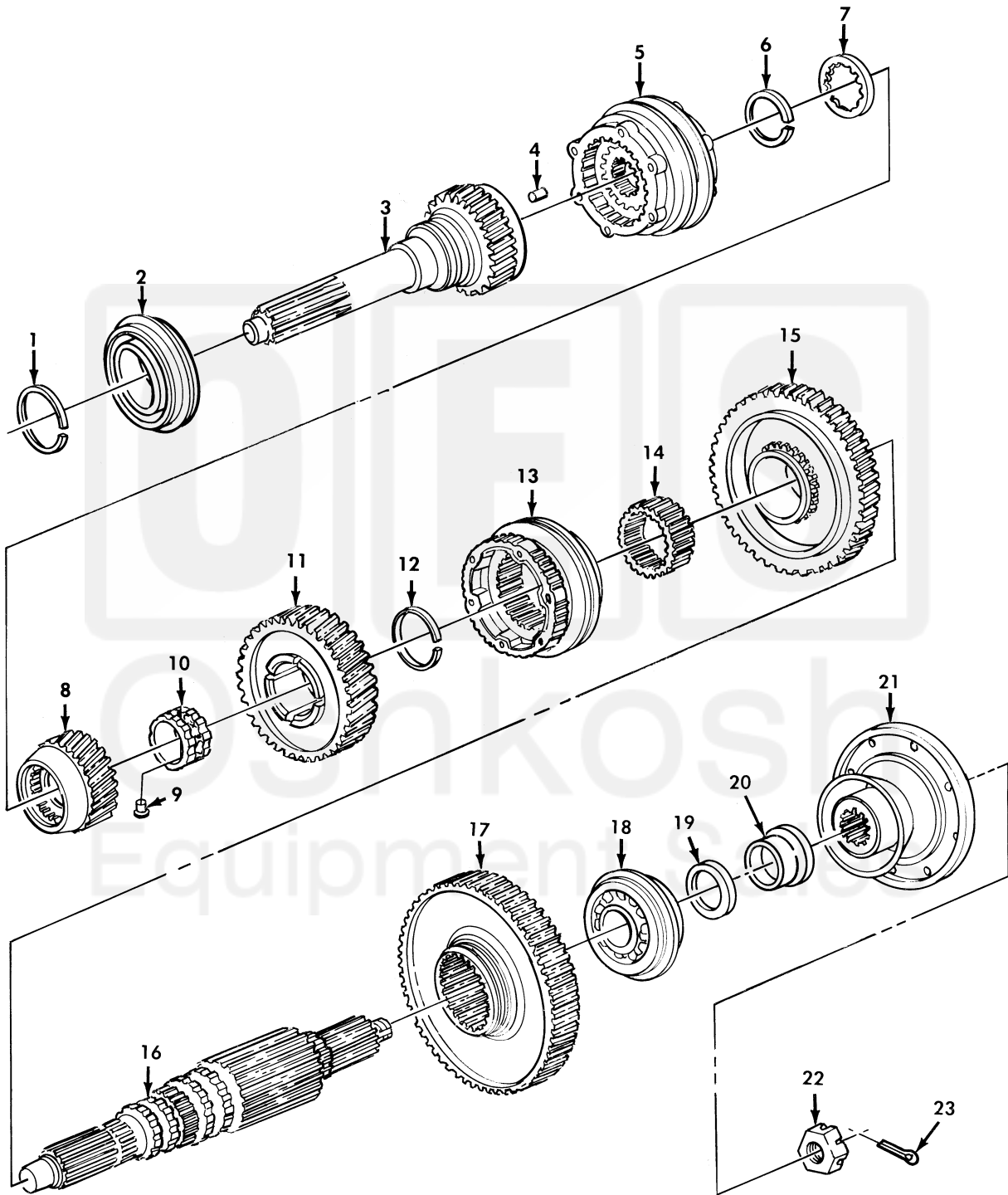

Figure 134. Transmission Synchronizers, Input, and Output Shafts.

(1) ITEM NO	(2) SMR CODE	(3) NSN	(4) CAGEC	(5) PART NUMBER	(6) DESCRIPTION AND USABLE ON CODE (UOC)	(7) QTY
GROUP 0701 TRANSMISSION SHAFTS						
FIG. 134 TRANSMISSION SYNCHRONIZERS, INPUT, AND OUTPUT SHAFTS						
1	PAHZZ	5325-00-734-6738	19207	7346738	RING, RETAINING . . . . .	1
2	PAHZZ	3110-00-155-6433	08162	1216SL	BEARING, BALL, ANNULA . . . . .	1
3	PAHZZ	3040-00-971-5019	95019	62-35-35	GEARSHAFT, HELICAL . . . . .	1
4	PAHZZ	3110-00-227-3401	29930	100085R1	ROLLER, BEARING . . . . .	14
5	PAHZZ	2520-00-734-7588	19207	7347588	SYNCHRONIZER, SHAFT, . . . . .	1
6	PAHZZ	5325-00-286-4437	19207	7346784	RING, RETAINING . . . . .	1
7	PAHZZ	3120-00-090-5968	19207	7346746	BEARING, WASHER, THRU . . . . .	1
8	PAHZZ	3020-00-971-5020	19207	8712210	GEAR, HELICAL . . . . .	1
9	PAHZZ	5315-00-292-4731	19207	7346744	PIN, STRAIGHT, HEADED . . . . .	1
10	PAFZZ	3120-00-857-9659	19207	10921763	BEARING, SLEEVE . . . . .	1
11	PAFZZ	3020-00-971-5022	19207	8712206	GEAR, HELICAL . . . . .	1
12	PAHZZ	5325-00-734-6787	19207	7346787	RING, RETAINING . . . . .	1
13	PAHZZ	2520-00-734-7587	19207	7347587	SYNCHRONIZER AND SL . . . . .	1
14	PAHZZ	3020-00-734-6748	19207	7346748	GEAR, SPUR . . . . .	1
15	PAHZZ	3040-00-734-6741	19207	7346741	GEARSHAFT, HELICAL . . . . .	1
16	PAHZZ	2520-00-562-0430	19207	7376164	SHAFT, MAIN, TRANSMIS . . . . .	1
17	PAHZZ	3020-00-734-6740	19207	7346740	GEAR, SPUR . . . . .	1
18	PAHZZ	3110-00-554-3450	29930	ST409	BEARING, BALL, ANNULA . . . . .	1
19	PAHZZ	5310-01-166-8580	19207	8711338	WASHER, RECESSED . . . . .	1
20	PAFZZ	4910-01-313-4621	80201	99293	REPAIR KIT, SLEEVE . . . . .	1
21	PAOZZ	2520-00-734-6802	78500	5WCS32-37A	FLANGE, COMPANION, VE . . . . .	1
22	PAFZZ	5310-00-492-9631	76040	A143813	NUT, PLAIN, SLOTTED, H . . . . .	1
23	PAFZZ	5315-00-298-1499	96906	MS24665-360	PIN, COTTER . . . . .	1

END OF FIGURE

